

# MGN 190 / 320 Gas Burner



## MGN 190/320 Gas Burner features:

- Energy saving and compatible with environmental requirements
- Quiet in operation and designed for easy maintenance
- Designed and approved in accordance with the European Standard EN 676
- Plug-in contact facilitates the installation
- Hinged flange for ease of servicing
- Designed for one stage, two stage or modulating operation
- Available for natural gas, LPG, town gas, biogas
- All kW ratings are nett CV



For more information on all Nu-way products  
please visit [www.nu-way.co.uk](http://www.nu-way.co.uk)



Enertech Group

| Type                |                    | MGN 190                        | MGN 320              |
|---------------------|--------------------|--------------------------------|----------------------|
| Capacity            | kW                 | 60-190                         | 60-318               |
| Motor               | V/Hz<br>W/A (Fuse) | 230 / 50<br>180 / 10           | 230 / 50<br>250 / 10 |
| Start / Run Current | Amps               | 5 / 2.3                        | 8.7 / 2.2            |
| Control box         |                    | Landis & Staefa                | Landis & Staefa      |
| Flame monitoring    |                    | Ionisation                     | Ionisation           |
| Air damper motor    |                    | •                              | •                    |
| Operation mode      |                    | 1 stage, 2 stage or Modulating |                      |
| Gross weight        | kg                 | 27                             | 29                   |
| Volume              | m <sup>3</sup>     | 0.13                           | 0.15                 |

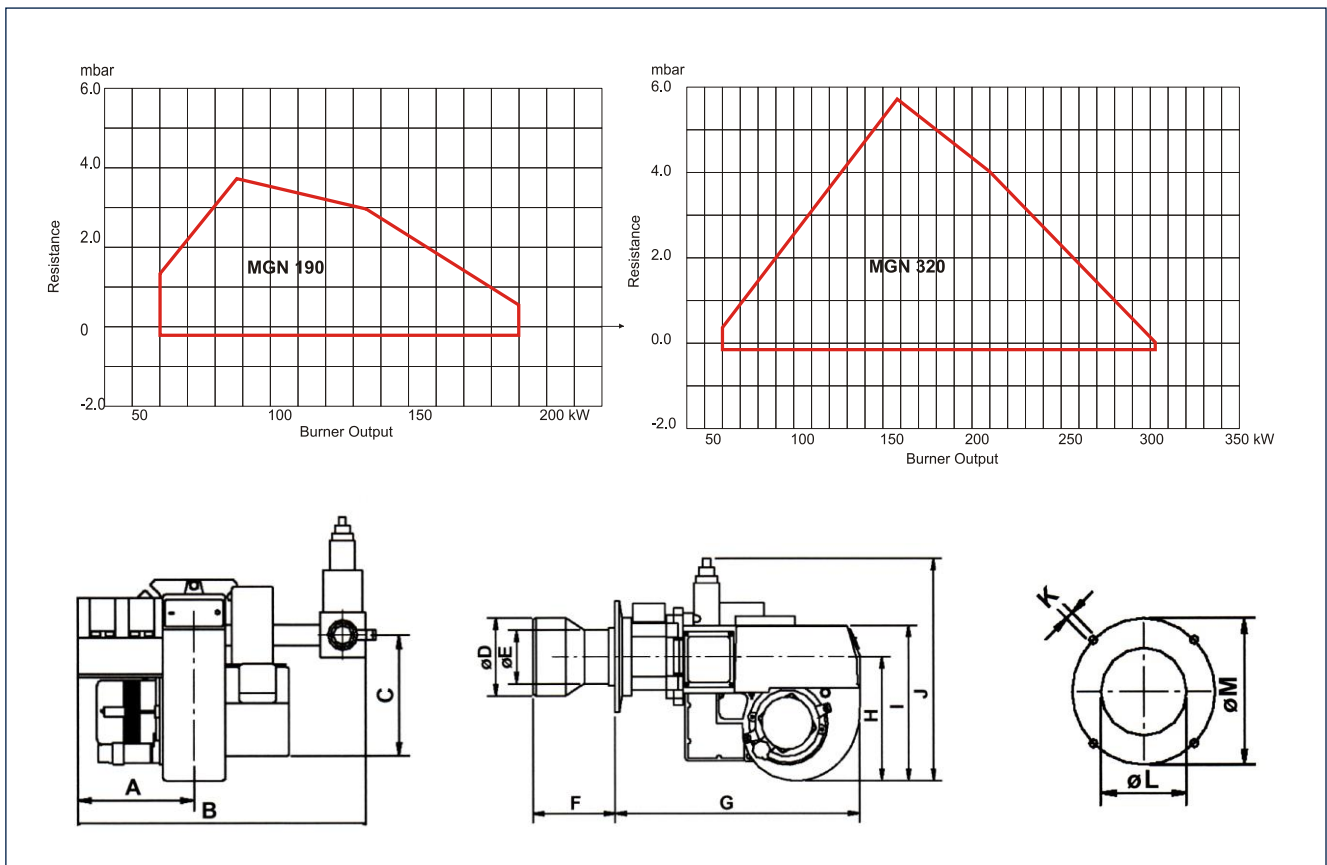

| Burner      | A   | B   | C   | øD  | øE  | F*  | G   | H   | I   | J   | K   | øL  | øM      |
|-------------|-----|-----|-----|-----|-----|-----|-----|-----|-----|-----|-----|-----|---------|
| MGN 190 S1L | 175 | 460 | 115 | 120 | 89  | 125 | 472 | 220 | 275 | 380 | M10 | 120 | 175-240 |
| MGN 190 T1L | 182 | 470 | 115 | 120 | 89  | 125 | 472 | 220 | 275 | 475 | M10 | 120 | 175-240 |
| MGN 320 S1L | 195 | 506 | 222 | 140 | 100 | 155 | 510 | 250 | 304 | 410 | M10 | 140 | 175-240 |
| MGN 320 T1L | 195 | 506 | 222 | 140 | 100 | 155 | 510 | 250 | 304 | 505 | M10 | 140 | 175-240 |

\* Extended Lengths Available

Enertech Limited, Ten Acres, Berry Hill Industrial Estate,  
Droitwich Spa, Worcestershire, WR9 9AQ

tel: +44 (0) 1905 794331 • fax: +44 (0) 1905 794017  
email: info@nu-way.co.uk • web: www.nu-way.co.uk



Enertech Group

23-10-2018